

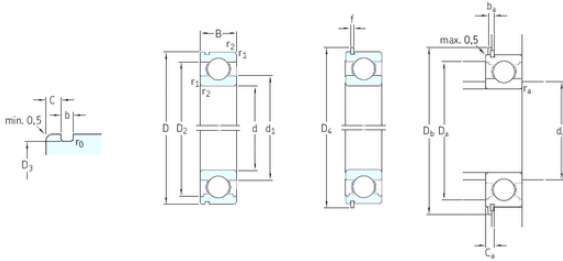

# CYRE BEARING LTD



40 mm x 110 mm x 27 mm SKF 6408N  
GERMANY Bearing 40\*110\*27

Bearing No. 6408N

6408N Bearing 2D drawings and 3D CAD models

Size	40x110x27 mm
Bore Diameter	40 mm
Outer Diameter	110 mm
Width	27 mm
d	40 mm
D	110 mm
B	27 mm
C	27 mm
b	2,7 mm
d1	62,8 mm
r0 max.	0,6 mm
r1 min.	2 mm
r2 min.	2 mm
C	3,28 mm
D2	87 mm
D3	106,81 mm
D4	116,6 mm
Ca max.	5,74 mm
da min.	3 mm
da max	53 mm
Da max.	97 mm
Db min.	118 mm
ra max.	2 mm
Weight	1,25 Kg
Basic dynamic load rating (C)	63,7 kN



## CYRE BEARING LTD

Basic static load rating (C0)	36,5 kN
Fatigue load limit (Pu)	1,53
Reference speed	14000 r/min
Limiting speed	9000 r/min
Calculation factor (f0)	12